

# Alogis Biñan 3

## Building Specifications

Features	Details
Unit Sizes	Ranging from 1,300 to 1,600 square meters
Floor Loading Capacity	Floor load: One (1) ton per square meter
Clear Height	Seven (7) meters
Building Envelope	150mm CHB Wall with 2 hours fire rating
Power Supply	Basic Cabling Facilities for 240V, 3P, 25 kVA requirement Individual metering with service entrance poles
Fire Protection	Centralized water cistern with fire/jockey pump, Wet Stand pipe, Siamese Connection, Fire Alarm Notifier, FDAS & Fire Exits
Restrooms	Male: 2 urinals / 2 toilet bowls / 2 wash bin Female: 2 toilet bowls / 2 wash bin PWD: 1 toilet bowl / 1 wash bin
Loading Bays	4.5 m height including roll-up frame x 4 m wide

# ALogis Biñan 3

## Building Specifications

Features	Details
Telecom	Outlet and conduit provision for internet and telecom thru main telephone terminal cabinet Coordinate with local telecom provider on other requirements
Utility/Electrical Room	Provision for 3m x 3m utility/electrical room
Lighting	High bay lighting for production area Provision for sky light or wall light for natural illumination
Water Supply	Industrial and domestic supply from local utility provider Individual meter for domestic and industrial supply
Drainage System	Tap to drainage system
Ventilation	Roof ventilators
Parking	Paved/Concrete
Others	MHE Ramp – 1 for every unit Perimeter fence – 2 meters in height Perimeter lights and building lights 0.5 meter CHB plus 1.5 meter metal grills fence (front) 2mx4m guard house Gravel bedding on easements

# Alogis Biñan 3

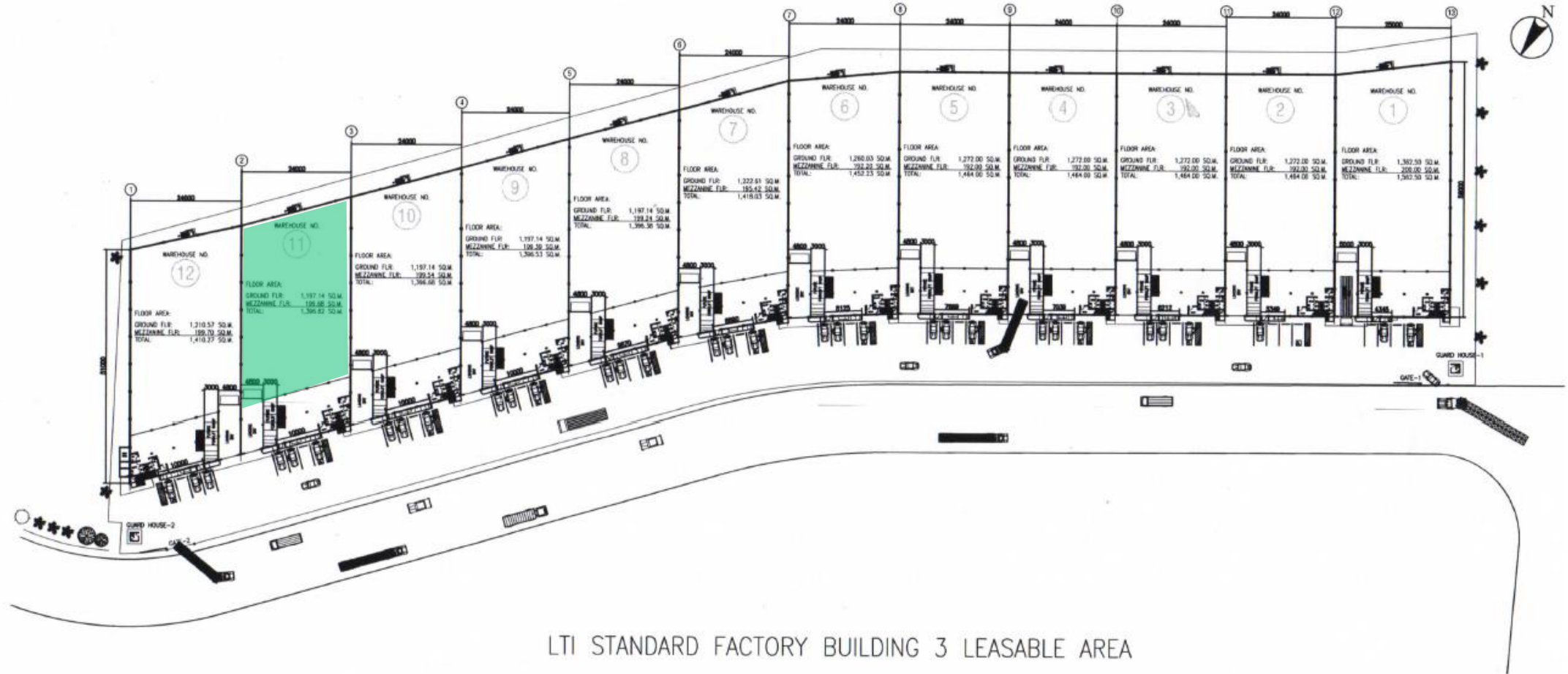

LTI STANDARD FACTORY BUILDING 3 LEASABLE AREA

RFO Unit 11: 1469sqm

# ALogis Biñan 3

## Floor Plan

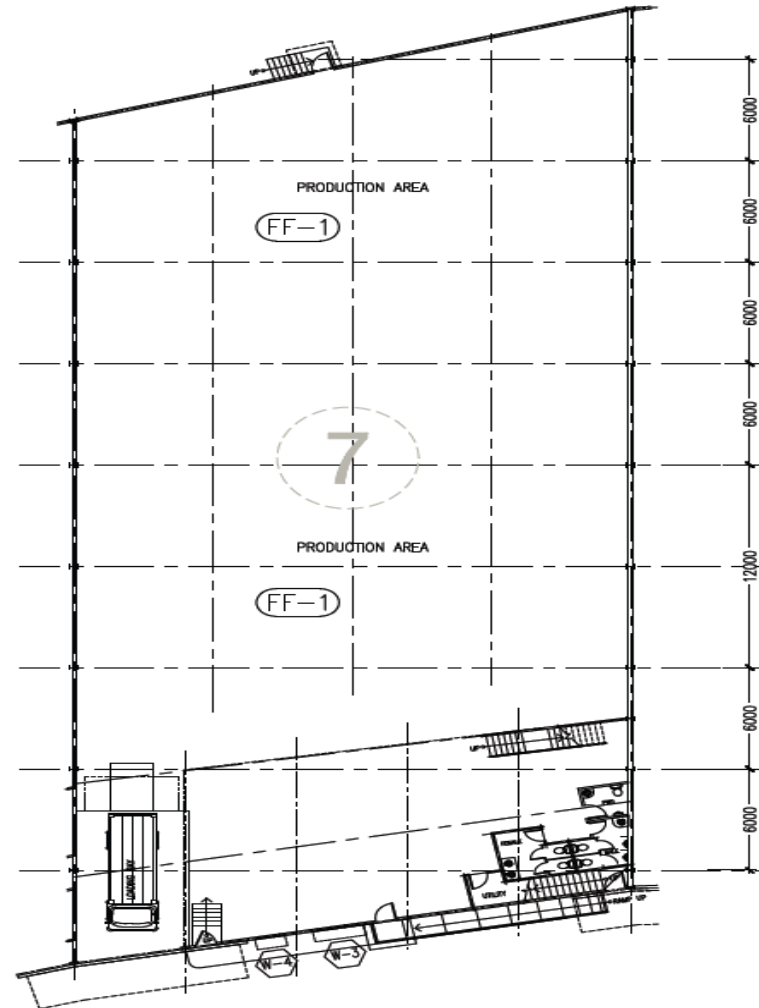

**TYPICAL FLOOR PLAN ALONG WAREHOUSE 7 - 12**